

Installation & Maintenance Instructions

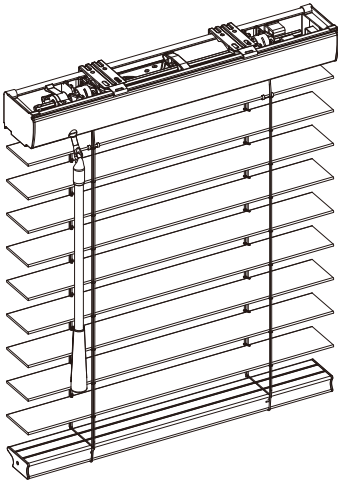

Getting Started



Remove the blind from the package. Be sure to keep the packaging until the blind operates to your satisfaction. Please take a moment to review the following installation guide for proper installation.

Recommended Tools

- Measuring Tape
- Pencil
- Level
- Screwdriver
- Power drill (1/4" hex driver and drill bit)



You will need to use the following fasteners for your particular mounting surface.

Mounting Surface	Fastener
Wood	1 1/4" Hexagonal Head Screw (Provided) 
Drywall/Plaster	Wall Anchors, Expansion Bolts (Not Provided) 
Metal	Sheet Metal Screws (Not Provided) 

Check Component / Hardware:

Check your package for contents needed for proper installation.

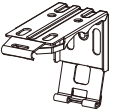

Installation bracket



1 1/4" Screw



Hold Down Bracket (Optional)

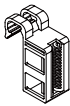

Valance Clip Receptor (Optional)

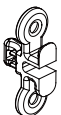

Valance Clip Plug (Optional)



3/4" Screw (optional)



Valance Return Connector (optional)



Wand

Hardware Standard Quantity

Blind Width (X)	X ≤ 37"	37" < X ≤ 47"	47" < X ≤ 60"	60" < X ≤ 75"	75" < X ≤ 96"
Installation Bracket	2	3	4	4	5
1 1/4" Screw for Installation Bracket	4	6	8	8	10
Wand	1				
Valance clip(optional)	2	3	3	4	4
Valance Return Connector for Modern Curved Valance(optional)	2				
Valance Return Connector for Designer Crown Valance(optional)	4				
Hold Down Bracket (only available for width 32" and under)	2				
3/4" Screw for Hold Down Bracket (only available for width 32" and under)	4				

Valance Return Connector is provide only when returns are required.

Step1.Bracket Installation

Mark the bracket location on the mounting surface. For easy installation and proper blind operation, use a level to ensure all brackets are alignment.

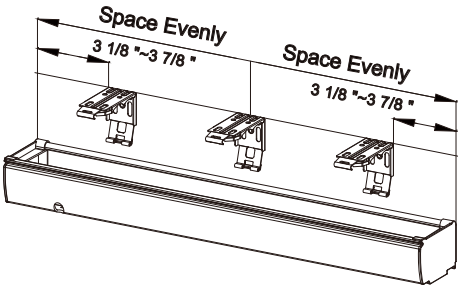

Allocate min. distance from wall face to the backside of the brackets. Pell off the double-sided adhesive tape on the bracket and stick the bracket at the marked location. Use two 1 1/4" mounting screws to secure bracket. Use wall anchors for drywall or plaster wall.

Inside Mount

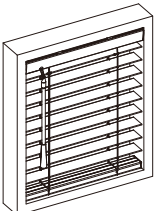

Without valance

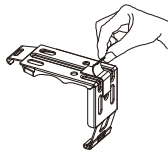

peel off the paper

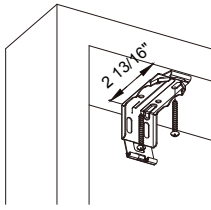

Installation Bracket Location

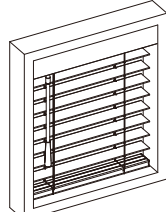

With valance no valance return

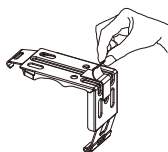

peel off the paper

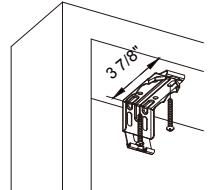

Installation Bracket Location

Semi-inside Mount (Bracket flush to wall)

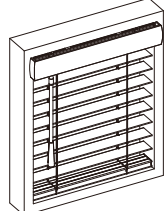

With valance and valance return

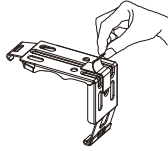

peel off the paper

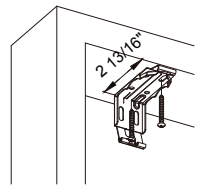

Installation Bracket Location

Outside Mount

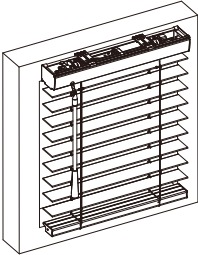

Without valance

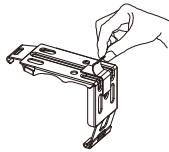

peel off the paper

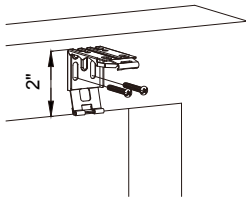

Installation Bracket Location

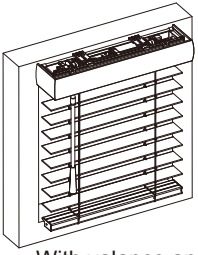

With valance and valance return

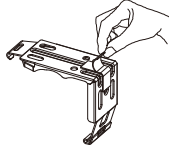

peel off the paper

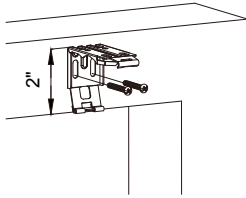

Installation Bracket Location

Step 2. Install the Valance Clip (for valance option)

- Attach the valance clip plug into the receptor. Refer to the right drawing for the plug position.

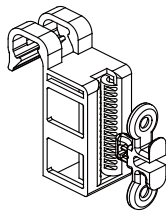

Attach the adjustable valance clip plug and receptor into the channel on the backside of the valance. Attach the valance return if needed. Hook the adjustable valance clip receptors onto the headrail and space them evenly.

Make sure receptors are not in obstructive position with the drum support or wand tilter inside the headrail and the brackets.

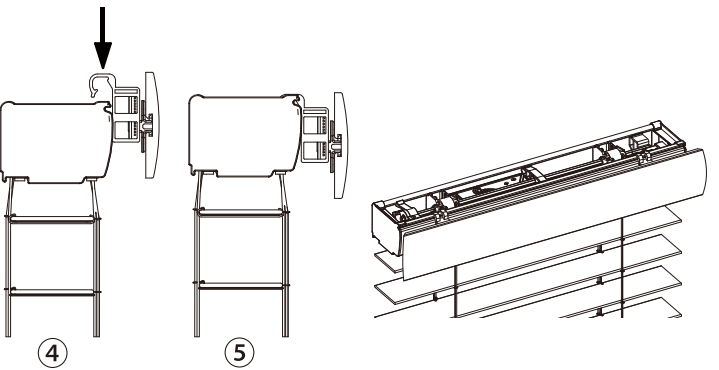
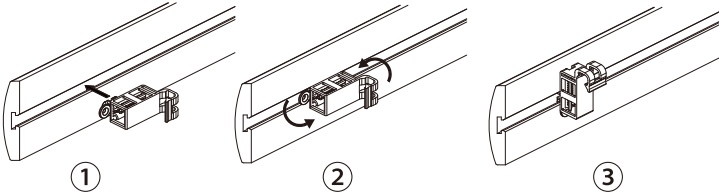
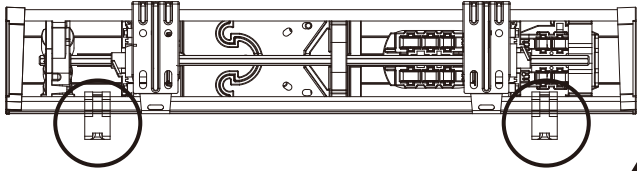

Remove the valance together with valance clip plug away from the receptors before installing the blind. **Leave the receptors on the headrail.**

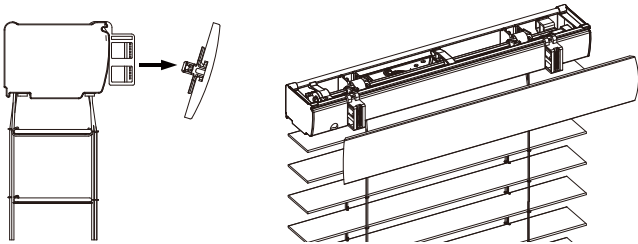

Step 3. Install the Blind

- For blind without valance, attach the headrail to the brackets directly as below drawing.

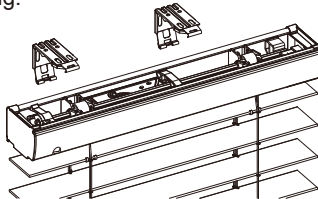

Without valance

- If valance is required, Make sure the adjustable valance clip receptors are attached on the headrail before installing the headrail.**

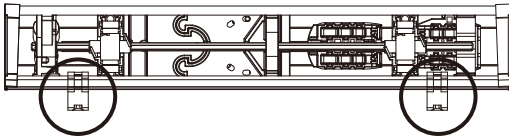

- Install the Blind as below drawing for valance option.

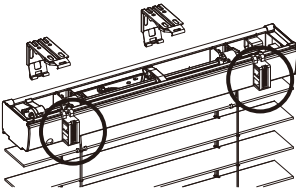

With valance

Choose one of below ways to attach the headrail to bracket.

- Start with attaching the headrail front to the bracket first.

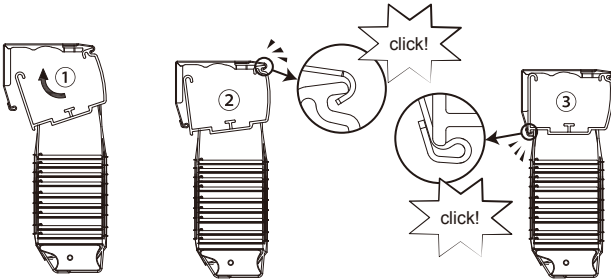

- Start with attaching the headrail back to the bracket first

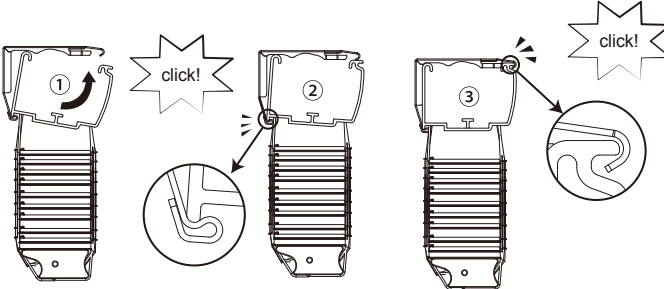

Step 4. Assemble the wand/split wand

- 1. If the wand is with connector, use the connector to join the two wands together. Make the wand aim at connector and push the wand into connector till to the end.
- 2. If the wand grip is not assembled, aim the wand at grip hole and push wand into the hole till to the end.

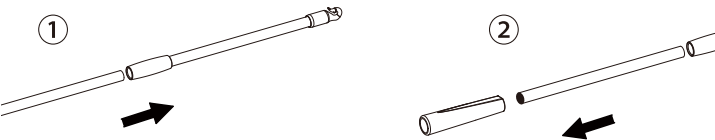

Step 5. Insert the Wand

Insert wand tilt connector into the bottom of wand tilter till they are clicked.

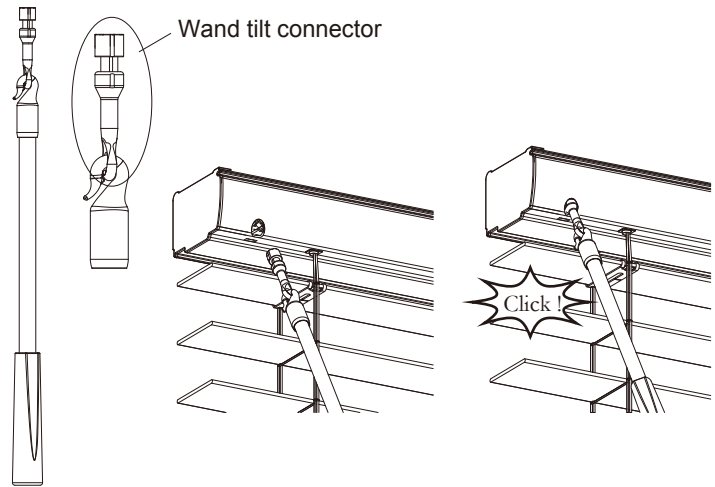

Step 6. Attach the Valance (for valance option)

Attach the valance to the headrail by inserting the plugs into the receptors.

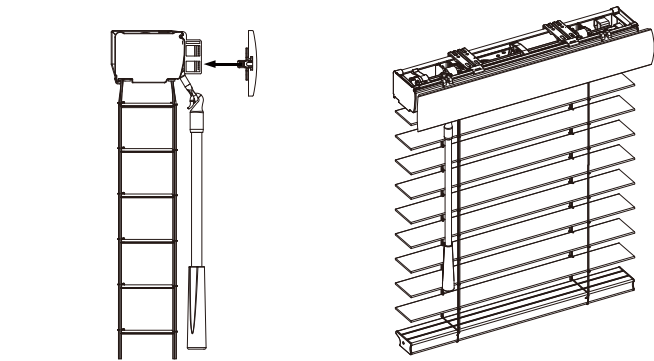

- For outside mount, the valance position can be adjusted as below drawing.

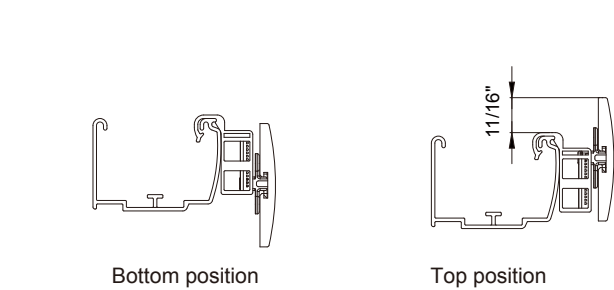

If the valance return is needed, join the valance return with valance by valance return connector first, and then attach the valance together with valance returns to the headrail.

Modern Curved Valance with valance returns(optional)

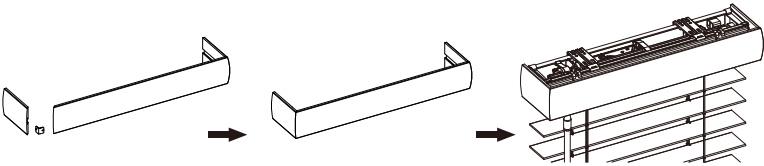

Designer Crown Valance with valance returns(optional)

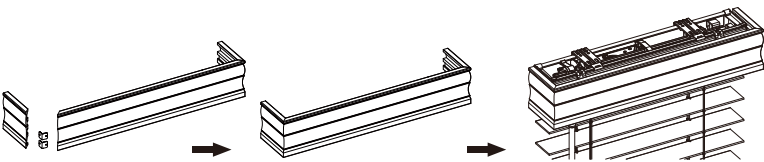

Operate Your Blind

Tilt wand
Rotate wand to attain desired slat position

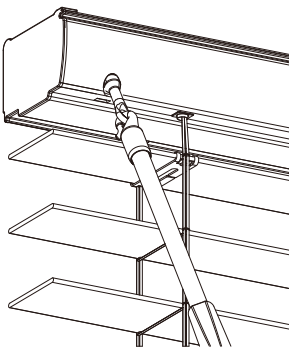

Lower the blind.
Pull the bottom rail down by hand
The slats need to be opened at any angle and keep even when lowering the blind.

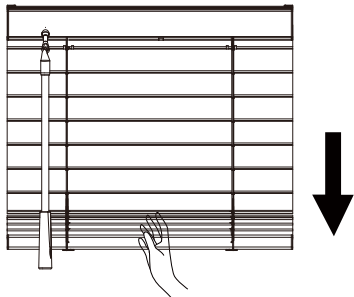

Raise the blind.
Lift the bottom rail up by hand
When raising the blind, we recommend that you gently tilt the slats toward you at 45 degree.

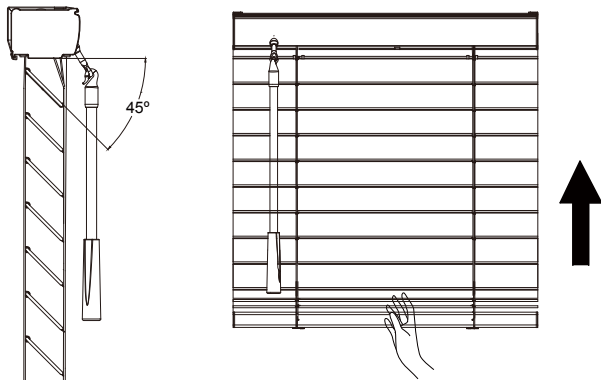

Additional Attachments

Hold down brackets (if included)
Attach the hold down brackets against a flat surface, horizontally or vertically, parallel to the bottom rail. Make sure the protruding area is aligned with the hole on the side of the bottom rail. Secure the hold-down bracket into the bottom rail on both sides to keep blinds in desired location.

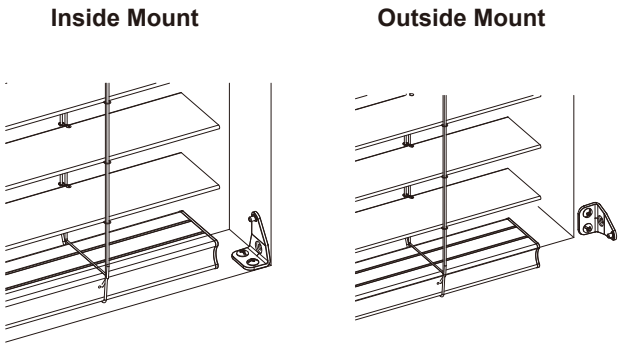

Remove the Blind

Remove the valance and valance clip plug away from the receptors first if valance is included.

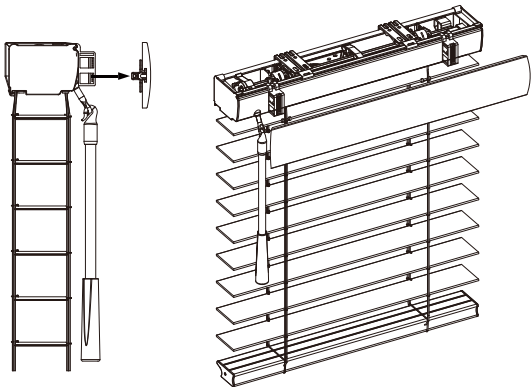

Remove the blind from bracket

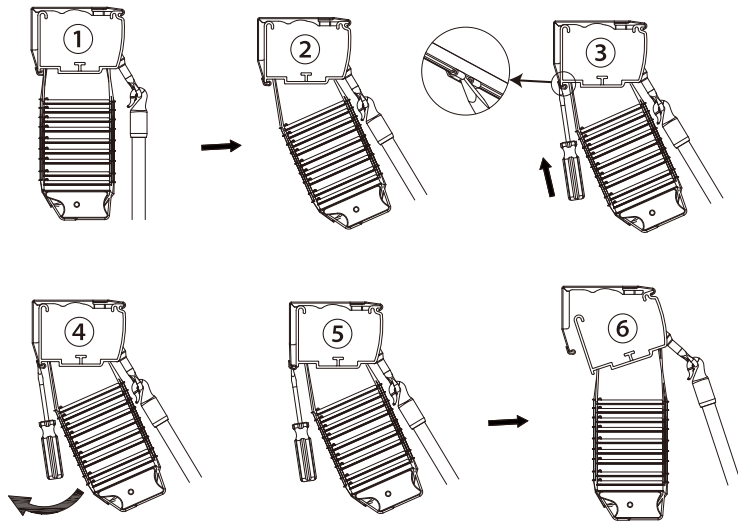

Cleaning Instructions

Perform periodic simple cleaning of your blind will keep your blind looking its best for the years to come. There are two ways to clean. You can dust it with a duster or dusting mitten, or simply use a soft cloth slightly moisten with lukewarm water to wipe down the slats. You can clean it with the blind hanging on the window, or you can take it down completely. By tilting the slats down but not fully closed, you will be able to clean most of the top surface of each slat. **Do not use detergent or abrasive cleaning solutions to clean the blind since it will likely cause damage to the blind.**

Side Mount Bracket Installation Instructions

Side mount bracket is only available for the arch window with blind width≤37".

Check Component / Hardware:

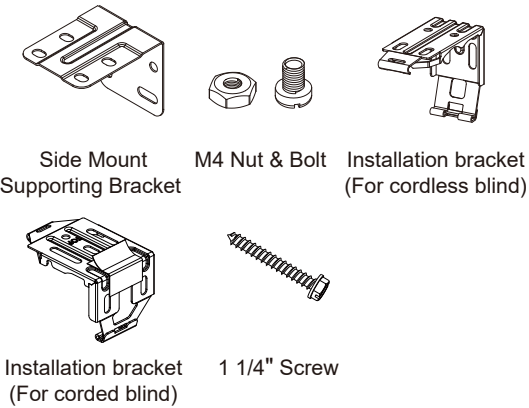



Getting Started

NOTE: Prior to installation, please make sure your hands are clean and free from any dirt or oil that could cause damage to the blind.

Recommended Tools

- Measuring Tape
- Pencil
- Level
- Screwdriver
- Power drill (1/4" hex driver and drill bit)

You will need to use the following fasteners for your particular mounting surface.

Surface	Fastener
Wood	1 1/4" Hexagonal Head Screw (Provided) 
Drywall/Plaster	Wall Anchors, Expansion Bolts (Not Provided) 
Metal	Sheet Metal Screws (Not Provided) 

Hardware Standard Quantity

Blind Width(X)	X≤37"
Installation Bracket	2
1 1/4" Screw for Installation Bracket	4
Side Mount Supporting Bracket	2
M4 Nut&Bolt for Side Mount Supporting Bracket	4 sets

How to assemble side mount bracket

For Cordless Blind: Align the side mount supporting bracket holes with the installation bracket holes, and then screw the M4 Nut & bolt into the diagonal holes for the left side mount bracket. Do the same for the right side mount bracket.

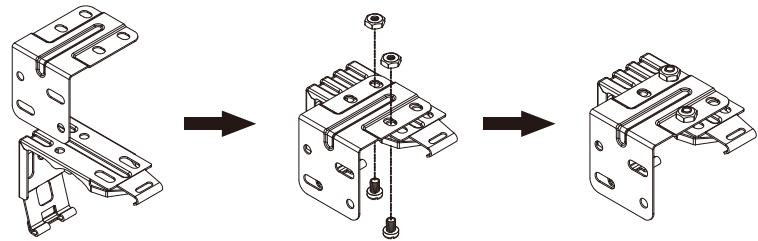

For Corded Blind: Align the side mount supporting bracket holes with the installation bracket holes, and then screw the M4 nut & bolt into the outside holes for the left side mount bracket. Do the same for the right side mount bracket.

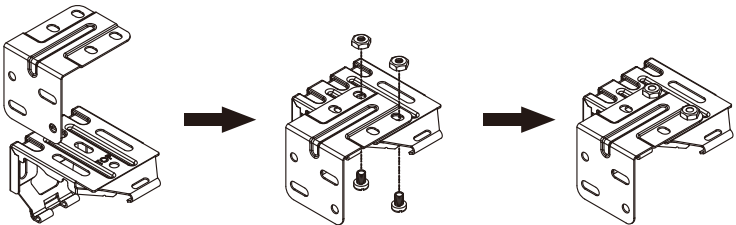

How to install side mount bracket

Peel off the double-sided adhesive tape on the bracket and stick the bracket at the marked location. Put two 1 1/4" mounting screws into the diagonal holes to secure bracket. Use wall anchors for drywall or plaster wall.

For Cordless Blind:

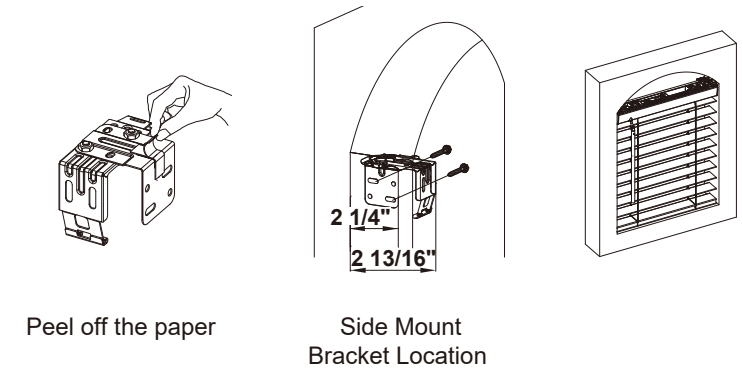

For Corded Blind:

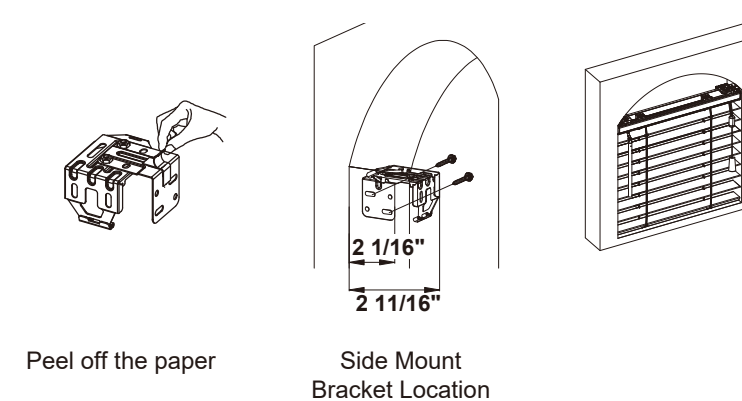

Note: For the blind installation, please refer to the installation instruction sheet in the hardware box.